



vimec

V6s
TECHNICAL CATALOGUE

OVERVIEW

V6s Curved staircases	225 kg 50x30 rail	300 kg 80x40 rail
Rail size (mm)	50*30	80*40
Min. stair width (mm)	945	1020
Slope (min-max)	0° - 50°	
Min. encumbrance of rail (mm)	100	135
Min footprint when platform is closed (mm)	370	400
Capacity (up to 45°)	225 kg	300 kg
Capacity (over 45°)	225 kg	250 kg
Speed	0.10 m/s	
Battery power supply	24 Vdc	
Power consumption	0,2 kW	
Usage environment	Indoor/outdoor	
Operating temperature	-5°C/ +60°C	
Complies with the European Directive 2014/30 "Electromagnetic compatibility"		
Compliant with machinery directive 42/2006		

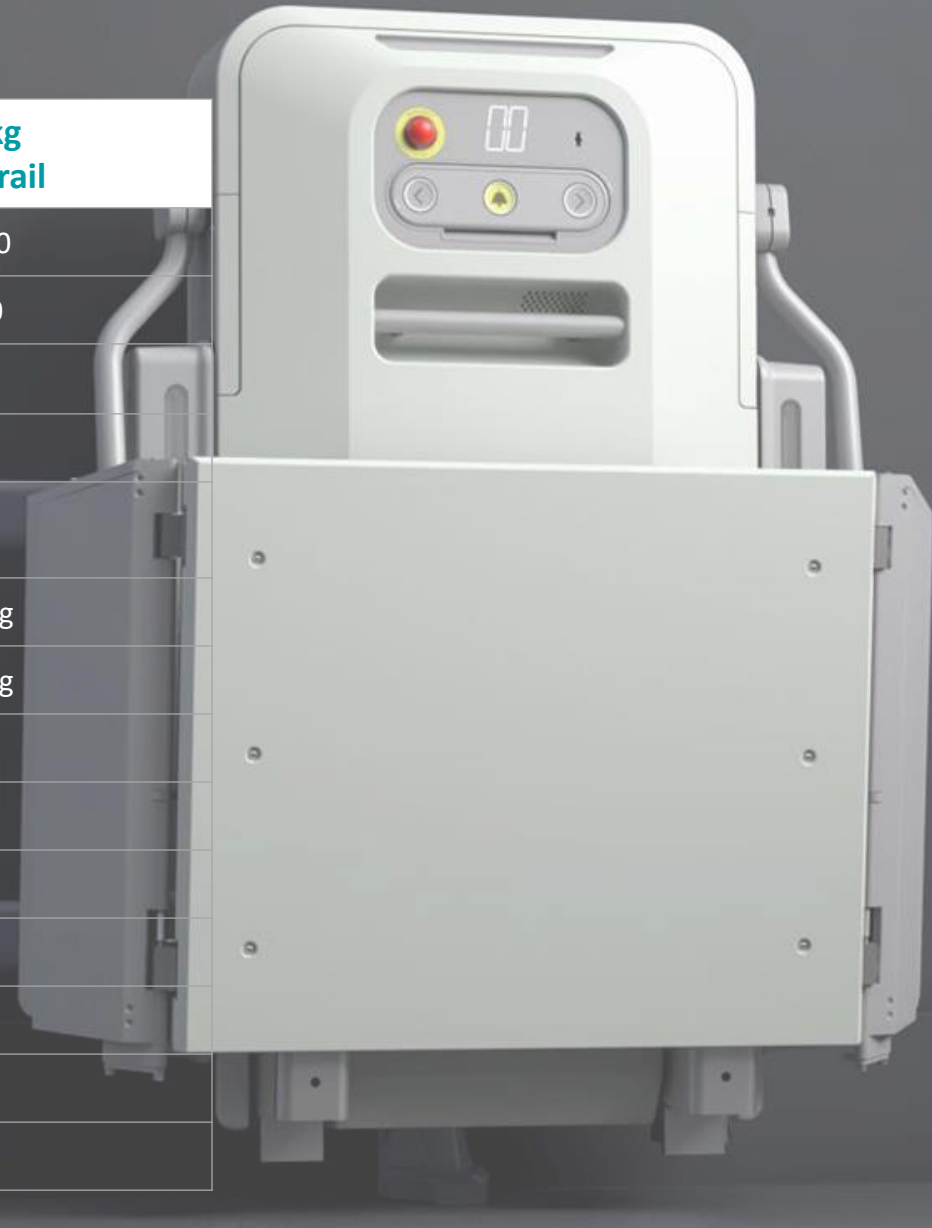

OVERVIEW

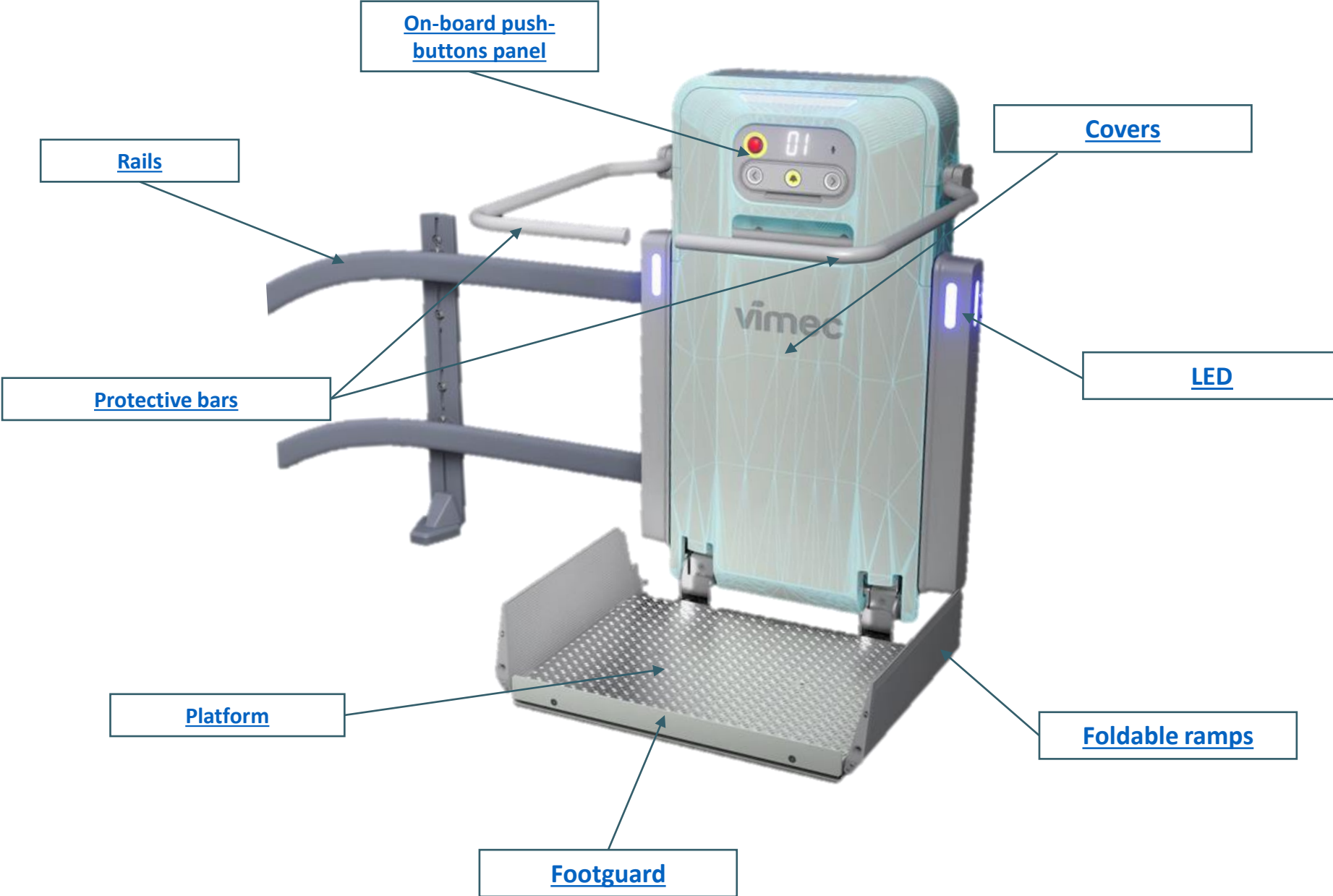

EN 81-40 - CHECKLIST



Below, we list all the points of the EN 81-40 standard respected by **V6s**:

Requirements	EN 81-40 ref.
Flame retardant and self-extinguishing materials	5.1.4.
Overload sensor (<i>std for 1250x800, opt for other platforms</i>)	5.1.6.2
Safety coefficient 2,5 for most load-bearing components	5.1.7
IP 44	5.1.8.2
Double chain traction with safety sensor	5.4.1.5
Driving pinion safety factor	5.4.5.1
Anti-trapping and anti-crushing guards	5.4.8.5
LED lights visual signs	5.5.16.2
Anti-slip walkable surface	5.6.4.1
Footguard 75 mm	5.6.4.4.3
Handrail	5.6.4.5.2
Gaps between bars = 100 mm	5.6.4.5.3
Interlocked arms 100N	5.6.4.7.7

VERSIONS – OVERVIEW

V6s with 80x40 rails										
L	<i>Platform width</i>	750	750	750	800	900	1000	1000	1250	
P	<i>Platform depth</i>	600	650	700	700	700	800	900	800	
	<i>Rail encumbrance w/ wall fittings (mm)</i>	TBD								
	<i>Rail encumbrance w/ std fittings (mm)</i>	135								
	<i>Rail encumbrance w/ self-supporting fittings (mm)</i>	215								
D	<i>Min. closed platform (also with seat)</i>	430			400					
D*	<i>Min. closed platform with foot guard EN81-40 (also with seat)</i>	445								
D**	<i>Min. closed platform with front access</i>	490								
	<i>Capacity up to 40°</i>	300 kg								
	<i>Capacity over 40°</i>	225 kg								

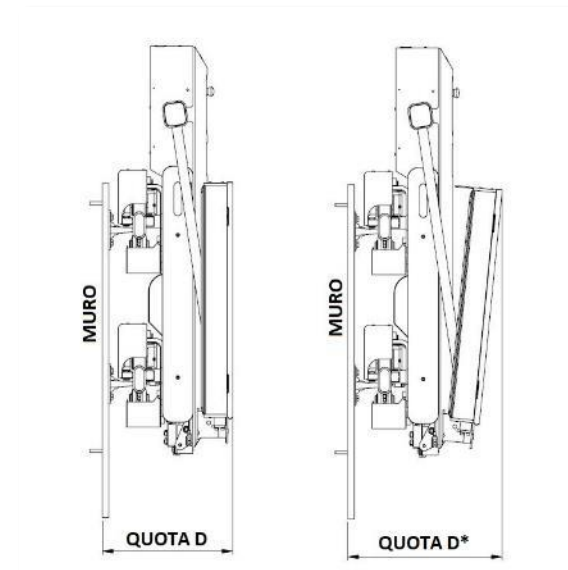

VERSIONS – OVERVIEW

V6s with 50x30 rails									
L	<i>Platform width</i>	750	750	750	800	900	1000	1000	1250
P	<i>Platform depth</i>	600	650	700	700	700	800	900	800
	<i>Rail encumbrance w/ wall fittings (mm)</i>	TBD							
	<i>Rail encumbrance w/ std fittings (mm)</i>	100							
	<i>Rail encumbrance w/ self-supporting fittings (mm)</i>	180							
D	<i>Min. closed platform (also with seat)</i>	400			370				
D*	<i>Min. closed platform with foot guard EN81-40 (also with seat)</i>	415							
D**	<i>Min. closed platform with front access</i>	445							
	<i>Capacity up to 40°</i>	225 kg							
	<i>Capacity over 40°</i>	225 kg							

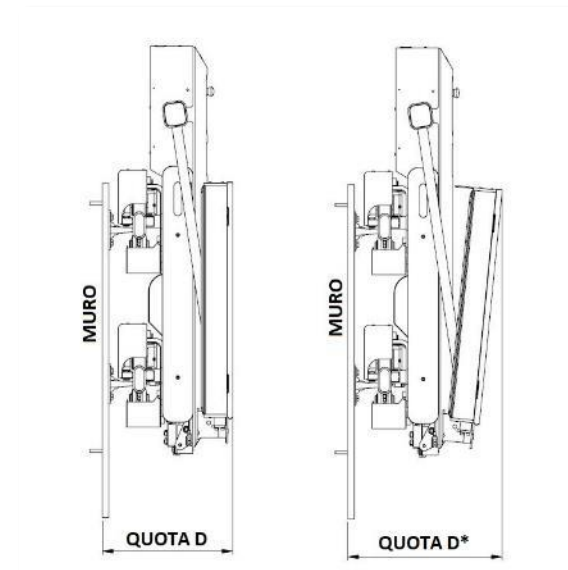

DIMENSIONS – MACHINE BODY

V6s with 80x40 rails

L	<i>Platform width</i>	750	750	750	800	900	1000	1000	1250
P	<i>Platform depth</i>	600	650	700	700	700	800	900	800
I	<i>Min. lateral encumbrance</i>	930	980	1030			1130	1230	1130
T	<i>Platform width with open flaps</i>	1120			1170	1270	1370		1620
T1	<i>Width with extended bars</i>	740			790	890	990		1240
H1	<i>Height with open bars</i>	1790	1840	1890			1990	2090	1990
R	<i>Bar Path Radius</i>	685	735	785			885	995	885

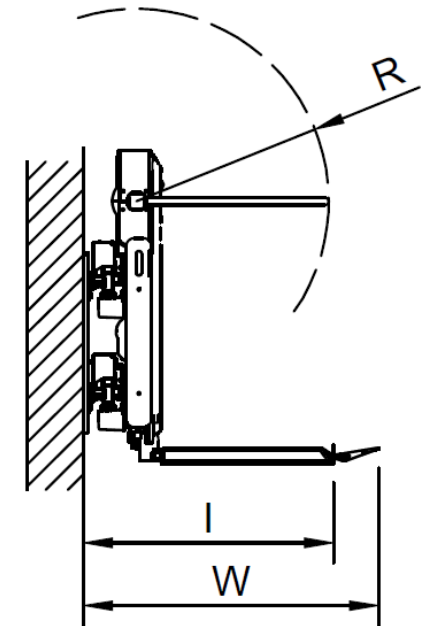
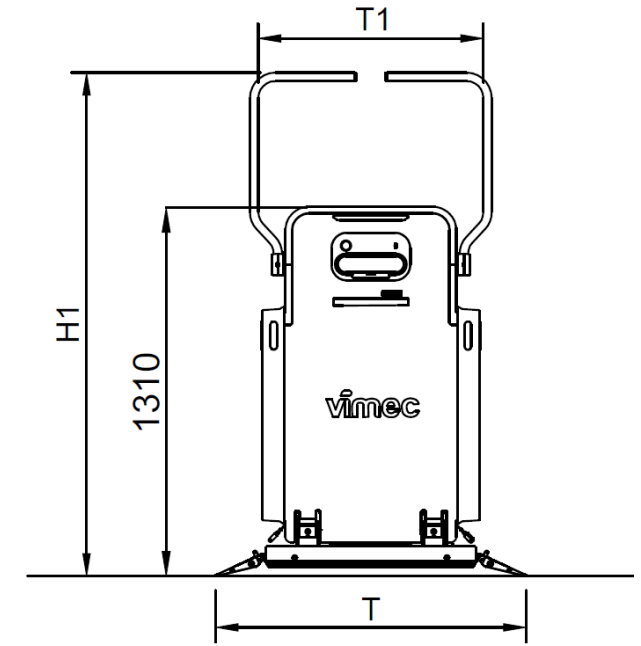
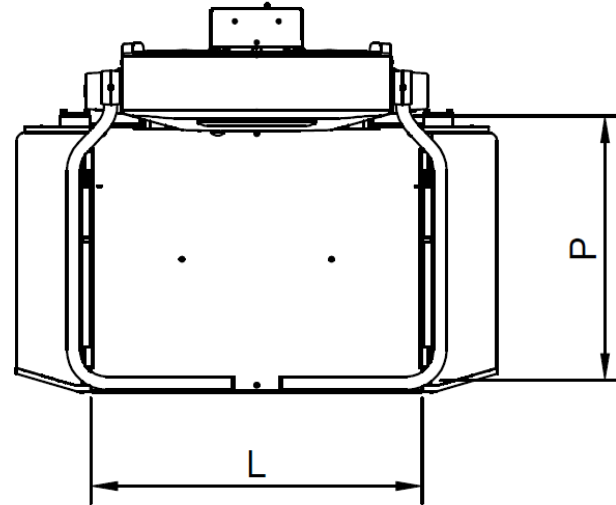

DIMENSIONS – MACHINE BODY

V6s with 50x30 rails

L	<i>Platform width</i>	750	750	750	800	900	1000	1000	1250
P	<i>Platform depth</i>	600	650	700	700	700	800	900	800
I	<i>Min. lateral encumbrance</i>	880	930	980			1080	1180	1080
T	<i>Platform width with open flaps</i>	1120			1170	1270	1370		1620
T1	<i>Width with extended bars</i>	740			790	890	990		1240
H1	<i>Height with open bars</i>	1790	1840	1890			1990	2090	1990
R	<i>Bar path Radius</i>	685	735	785			885	995	885

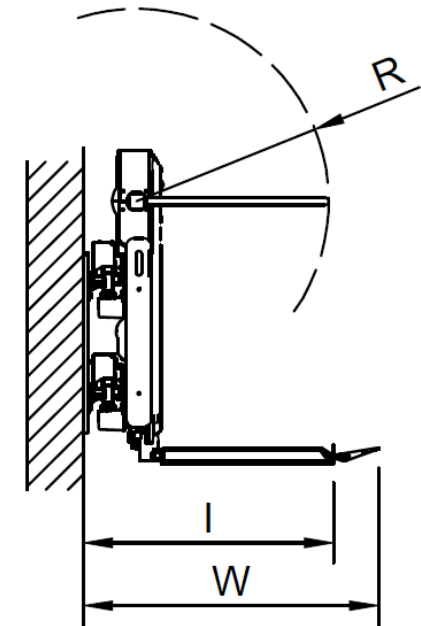
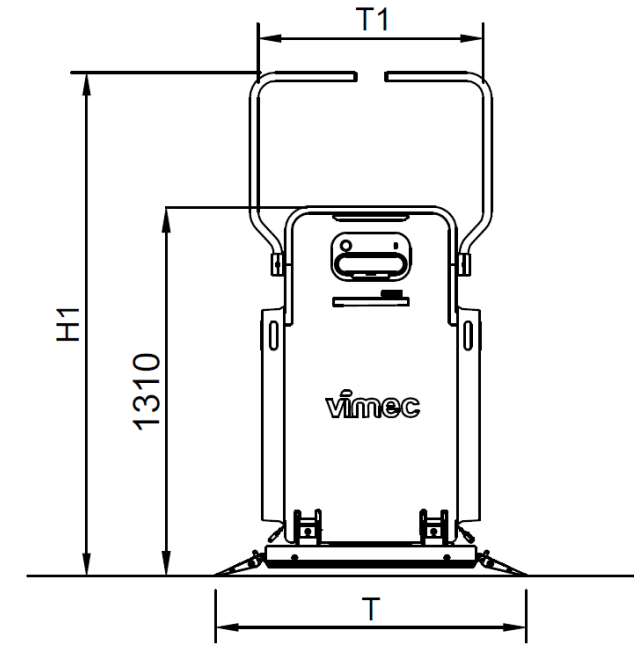
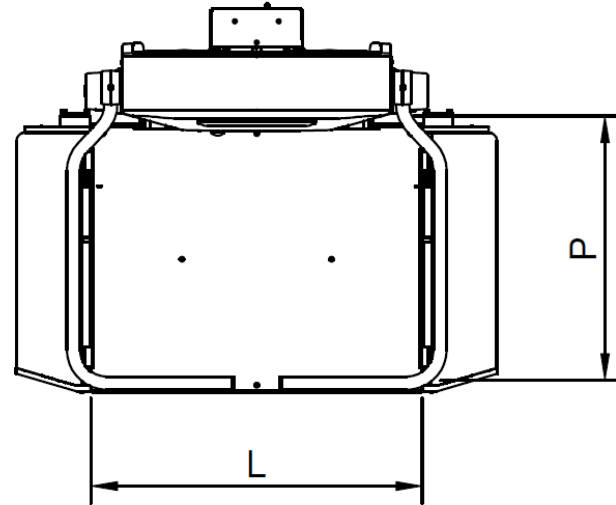

DIMENSIONS – FRONT VIEW

V6s with 80x40 rails

V6s with 80x40 rails									
L	<i>Platform width</i>	750	750	750	800	900	1000	1000	1250
P	<i>Platform depth</i>	600	650	700	700	700	800	900	800
A	<i>Lateral ascent (w/ drop nose)</i>	2190		2240	2340	2440		2690	
B	Landing rail footprint (w/drop nose)	990		1040	1140	1240		1490	
N	Machine footprint on starting landing (w/drop nose)	1190		1240	1340	1440		1690	
C	Bars in working position	1810		1825	1855	1885		1960	

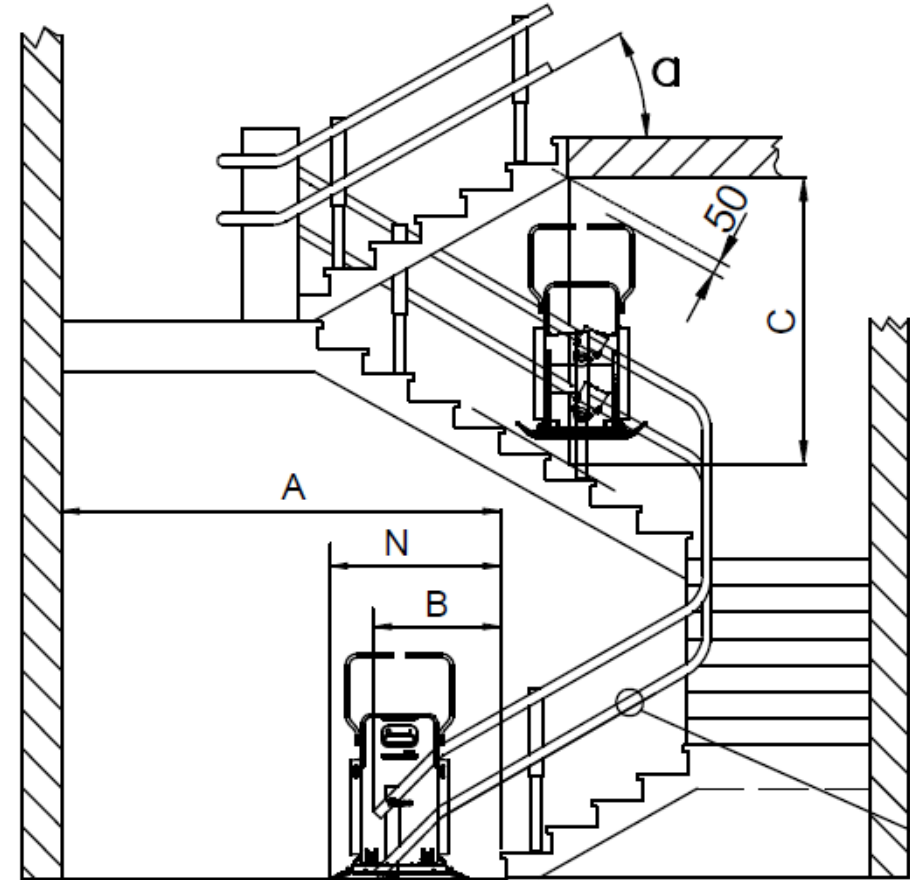

DIMENSIONS – FRONT VIEW

V6s with 50x30 rails

L	Platform width	750	750	750	800	900	1000	1000	1250
P	Platform depth	600	650	700	700	700	800	900	800
A	Lateral ascent		2190		2240	2340		2440	2690
B	Landing rail footprint (w/drop nose)		990		1040	1140		1240	1490
N	Machine footprint on starting landing (w/drop nose)		1190		1240	1340		1440	1890
C	Bars in working position		1810		1825	1855		1885	1960

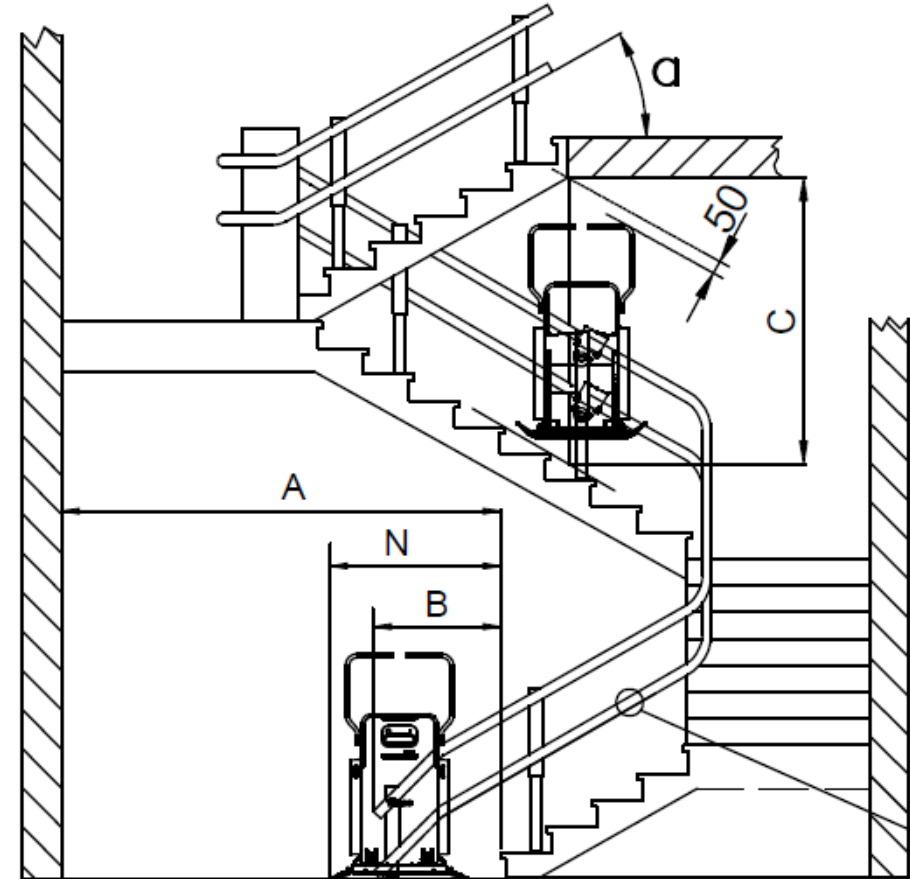

DIMENSIONS – VIEW FROM ABOVE

V6s with 80x40 rails

L	Platform width	750	750	750	800	900	1000	1000	1250
P	Platform depth	600	650	700	700	700	800	900	800
F 0<M<110		380							
F 110<M<190		460							
F M>190		460 + M							
LS	With rounded flaps	1020	1060	1105	1115	1130	1240	1340	1310
	With flaps NOT rounded	1035	1075	N.A.	N.A.	N.A.	N.A.	N.A.	N.A.
	With front access	1090	1150	1205	1210		1310	1420	1355

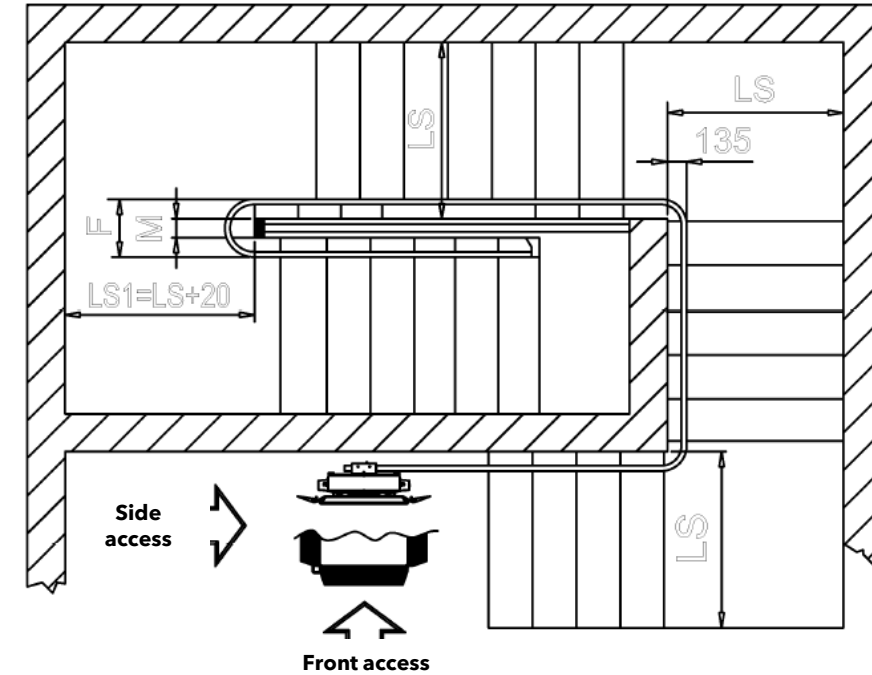

DIMENSIONS – VIEW FROM ABOVE

V6s with 50x30 rails

L	<i>Platform width</i>	750	750	750	800	900	1000	1000	1250
P	<i>Platform depth</i>	600	650	700	700	700	800	900	800
F 0<M<110		310							
F 110<M<160		360							
F 160<M<210		410							
F 210<M<260		460							
F M>260		M + 200							
LS	<i>With rounded flaps</i>	960	1005	1050	1060	1075	1185	1280	1255
	<i>With flaps NOT rounded</i>	980	1025	N.A.	N.A.	N.A.	N.A.	N.A.	N.A.
	<i>With front access</i>	1055	1100	1150	1155	1160	1270	1380	1320

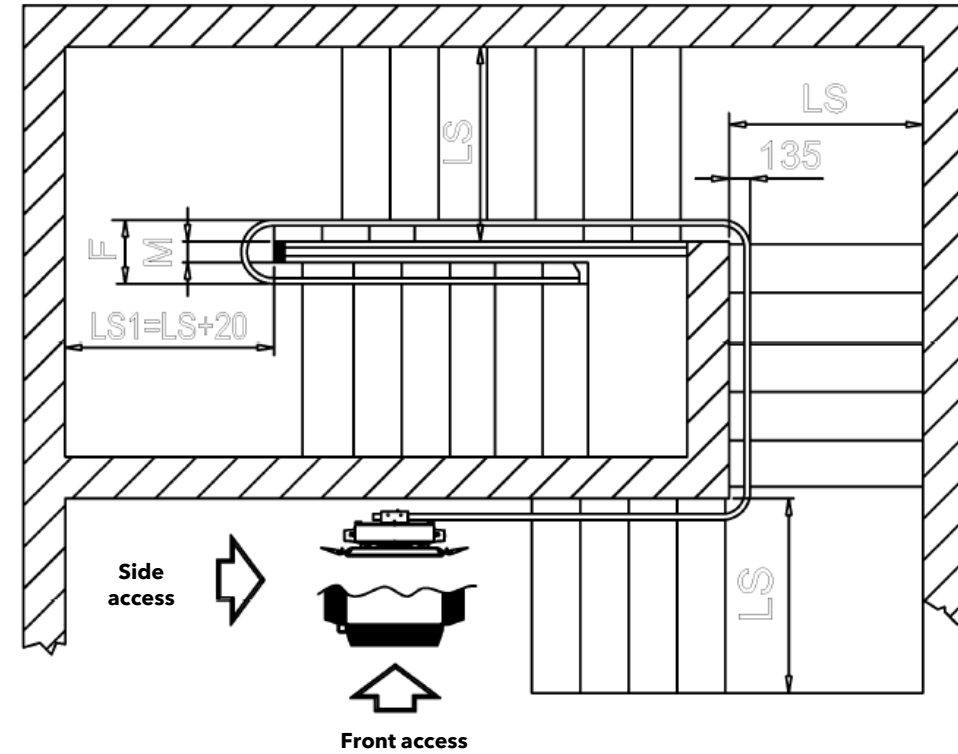

DIMENSIONS – CLOSED PLATFORM HEIGHT FRONT ACCESS

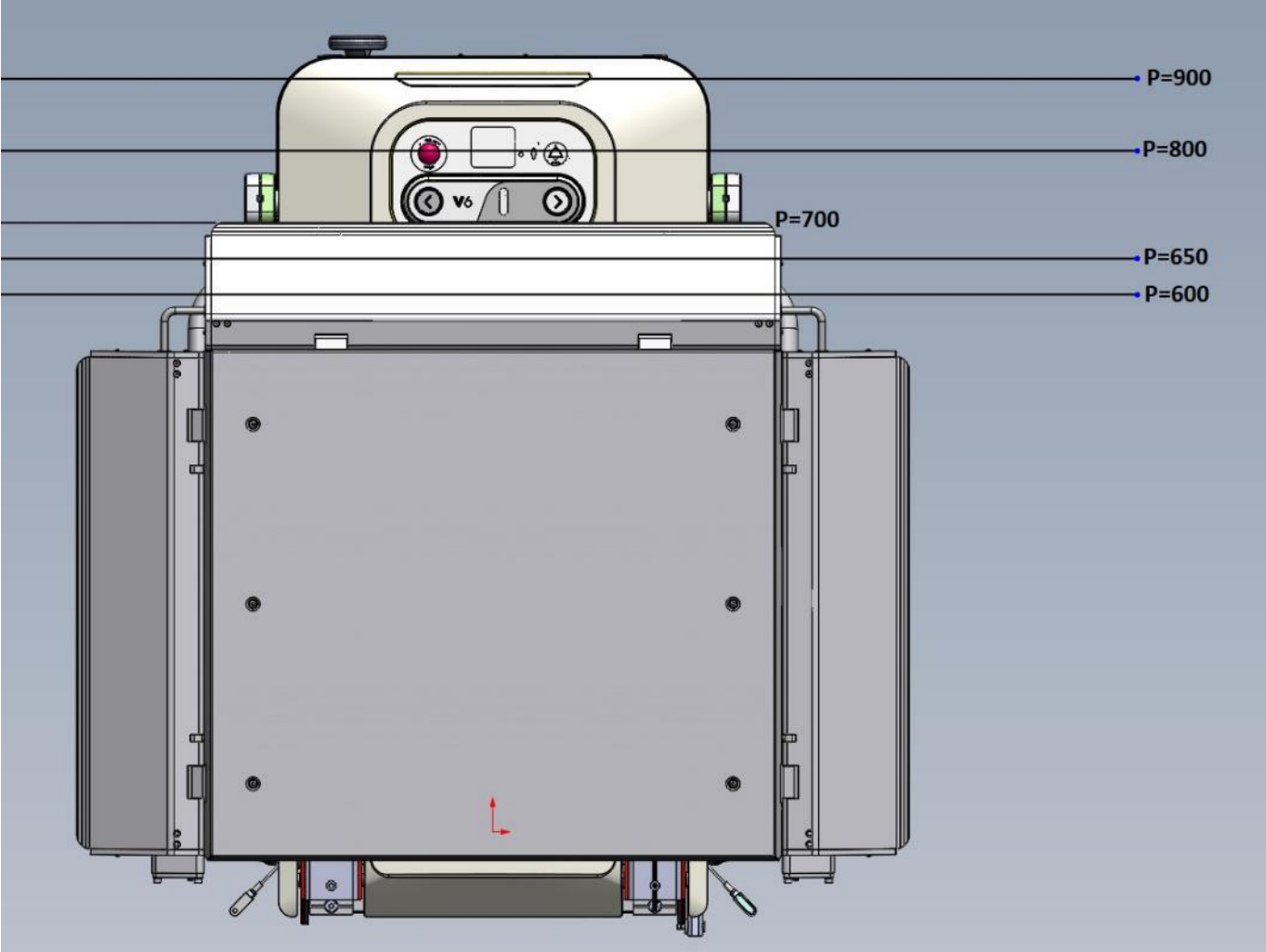

DIMENSIONS – CLOSED PLATFORM HEIGHT LATERAL ACCESS

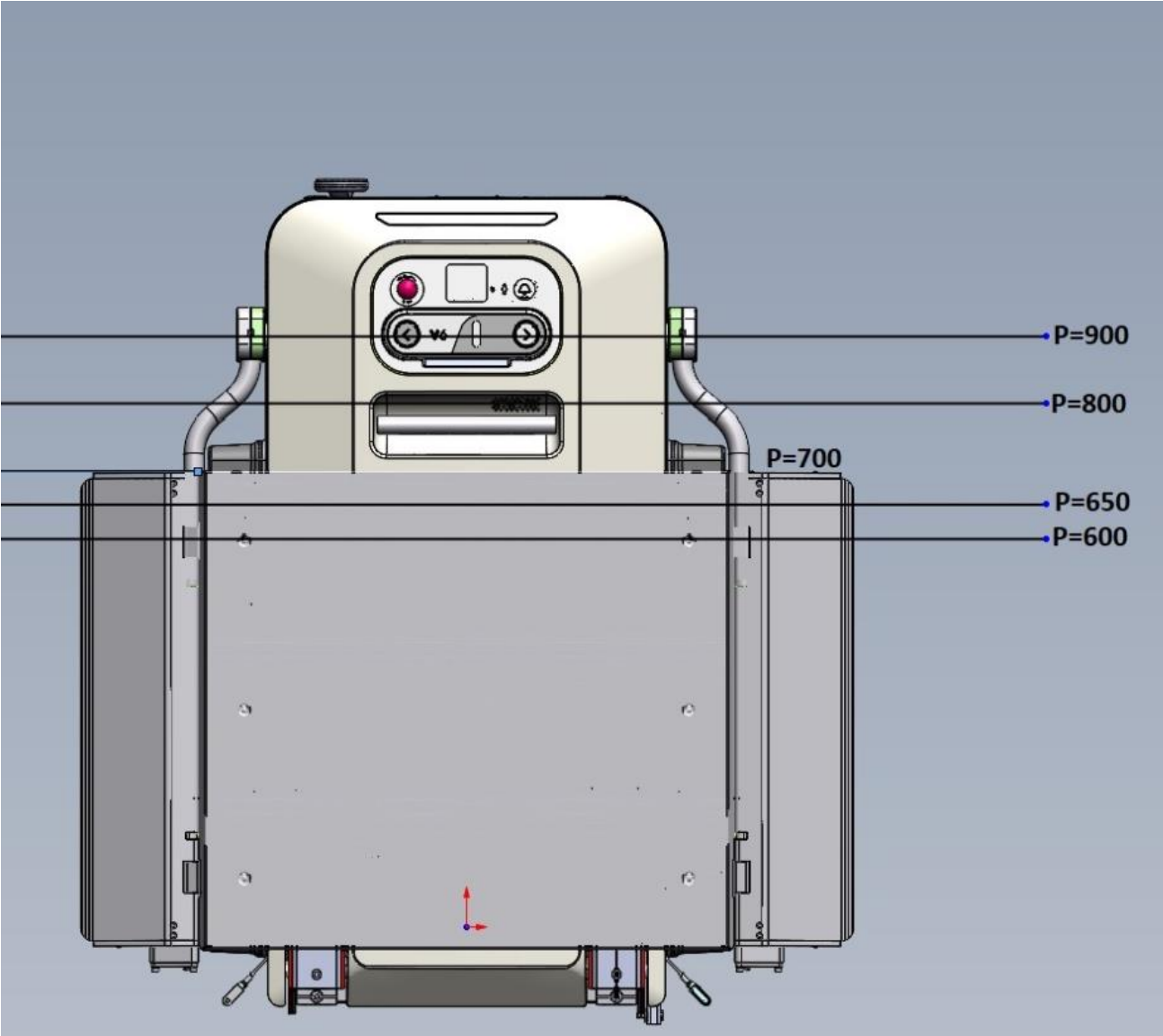

SALES MEMO – ON-BOARD CONTROLS

Recessed red stop button to prevent accidental activation



Backlit display as standard - it disappears when the machine is idle



In RAL 7047 Telegrey 4 for all versions



Directional buttons with extended active part – the whole area can be easily activated even without the use of hands!



ON-BOARD PUSH-BUTTON PANEL

The standard on-board push-button panel is made of thermoplastic material and is 170 x 280 mm in size.

The on-board control panel includes:

- Round directional buttons with arrow for ascent and descent
- Emergency "bell" button
- Stop button
- [Display and indicator lights](#)
- Magnetic activation key

The **arrow** and **bell buttons** are rounded and have a diameter of 40 mm – the entire surface is active to allow you to press the button more easily even without the use of your hands. Only the directional keys have the backlit crown.

The operation of the two directional buttons is of “dead’s man” type and it is therefore necessary to constantly hold the button until the platform reaches the floors and stops automatically.

The **bell button** is always active regardless of the status of the key and it activates an **audible alarm** and the **auto-dialer** when present.



DISPLAY AND INDICATOR LIGHTS

Overload light

Orange LED

- [Overload sensor](#) standard for 1250x800
- Optional for other platforms

Fault reporting White LED

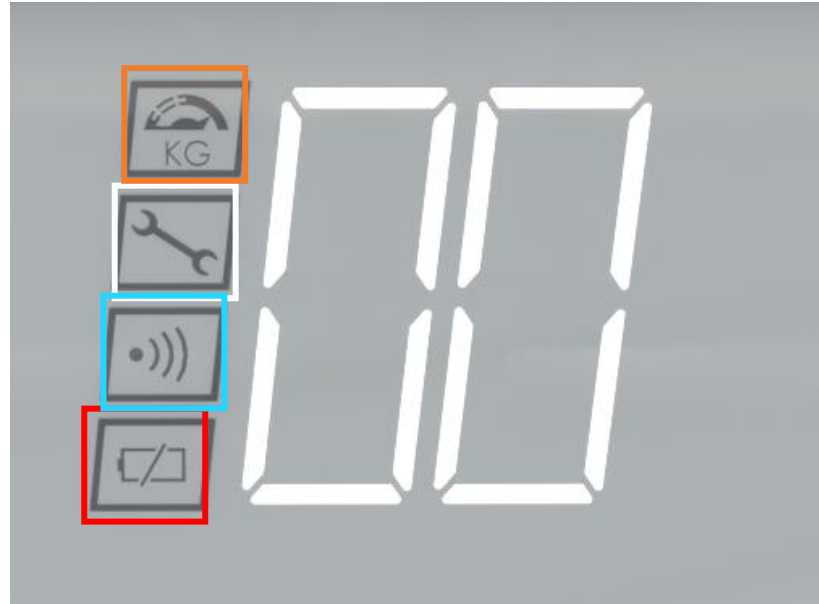

Radio signal reception

White LED

It is activated when the floor remote control or the remote control for attendant is used.

Battery signal

Green LED: battery charged

Orange LED: battery not fully charged

Red LED: low battery

V6s is equipped as standard with an **LED light display** located behind the dashboard cover. The symbols appear via backlight and then, when the machine is not running and not in error, the display is not visible.

The display provides information on the status and activity of the machine, in particular:

- **DIRECTION OF TRAVEL:** the display shows directional arrows in motion
- **FLOOR** where the car is located
- **ERROR CODES:** When the machine is in error, the display shows the corresponding error code to facilitate the technician and/or users in resolving the problem. Some errors are recoverable and can be fixed directly by the user through the user manual or the [app MyVimec](#).

OTHER FEATURES

All the V6s are integrated with an **aluminum handle** placed in the upper part of the stairlift is used as a support during the motion.

The "recessed" position of the handle avoids any accidental impact.

The length is 268 mm, and the diameter is 25 mm.

Compliant with regulation [EN 81-40, 5.6.4.5.2](#), the space around the handle must be greater than 30 mm to ensure a comfortable grip for users.

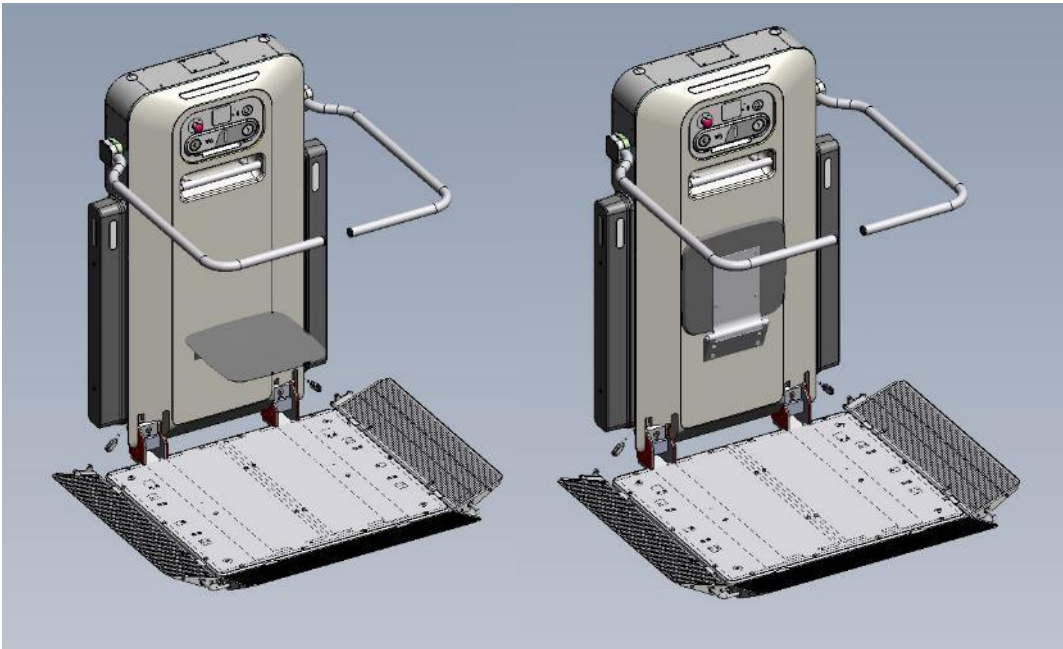

A **folding seat** with a maximum capacity of 115 kg can also be ordered as an option.

The presence of the seat does not affect the footprint of the closed machine.

LED

V6s is equipped to standard with **3 RGBW LED strips**, one positioned above the control panel and 2 placed on each side bumper.

The LEDs provide in an intuitive and immediate way some information on the status and activity of the machine, in detail:

- **GREEN LED fixed**
Machine ready to be used
- **BLUE LED flashing**
Moving machine
- **RED LED flashing**
Movement not possible (e.g. due to obstruction)
- **RED LED fixed**
Machine in error
- **GREEN LED flashing**
Machine in self-centering zone
- **YELLOW LED flashing**
Machine called from the floor



COVERS

V6s has been designed to adapt to every condition and environment of use.

In particular, all hoods, caps and side panels have an **IP 44** rating which means that "internal" electrical and electronic devices are protected against the penetration of solid foreign bodies with a diameter of 1 mm and above and is protected from splashing water from all directions.

In addition, these components are fireproof or self-extinguishing and classified as **V0** according to the UL94 standard "Degree of Extinguishing of Plastics" – this means that in the event of a fire, the flame is extinguished within 10 seconds.

 **COMPLIANT** Compliant with regulation [EN 81-40, 5.1.4](#)

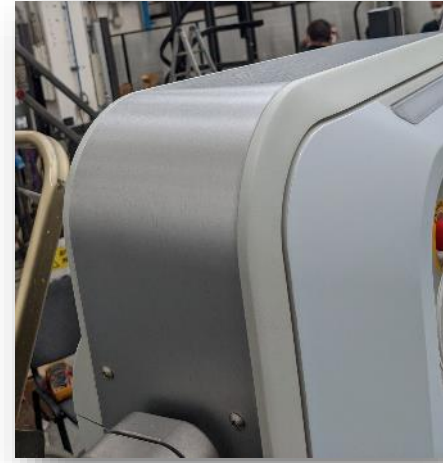

Upper Hood

Front cover available in
RAL 9018 or 7024 and
side panels



Rear covers



vimec

SALES MEMO – PROTECTIVE BARS

ALUMINIUM
RAL 9006



SIMPLE MANUAL UNLOCKING



DISTANCE BETWEEN BARS IN
ACCORDANCE WITH 81-40
Between 100 and 150 mm



 COMPLIANT



FOLDABLE
DOWNWARDS



INTERLOCKED BARS

Resistant to an applied force of 100
Newtons both upwards and downwards



 COMPLIANT

FLOOR CONTROLS

In the standard equipment of V6s, 2 floor radio push-button panels are included, one to be installed on floor 0 and one on floor 1.

The push-button panels consist of a wall housing and a removable remote control.

Using the **O** "call" button, the machine is called back to the desired floor.

Using the **P** "parking" button, the machine is sent to parking.

All push-button panels are enabled by a **removable magnetic key** (in orange) - you cannot use the machine without the key being inserted. 2 keys are provided for each standard supplied push-button panel (4 keys in total).

The remote control is supplied with a 3.7V rechargeable battery.

As with the on-board controls, all the floor controls are "dead's man" type (just remove your finger from the button and the machine stops).



ACCESS – PLATFORM

V6s is always equipped with a **motorised platform** through an electromechanical actuator - it is necessary to keep the C button pressed on the push-button panel for the platform to open automatically, the connecting flap will be placed in the boarding position and the descent side bar in the working position.



A special manual manoeuvre allows you to close the platform in emergency conditions (see dedicated [slide](#)).

The platform is also protected by **safety flaps** on the right and left sides, with lateral access, and on 3 sides with front access (optional), which have the dual function of facilitating the ascent to the floors (open position) and containing the wheelchair during the path of the machine. Before the machine leaves the plane, the flaps are automatically brought to the safety position (inclined at 75°).

The flap facing the descent opens only on the lower floor of the path. In case of resistance to the movement of the flaps, an overcurrent protection intervenes by blocking the recalled function.

In case of standard side access, the platform is always equipped with a **front foot guard** with a standard height of 5.5 cm.

As an option, the foot guard is available EN 81-40 with height 7.5 cm.

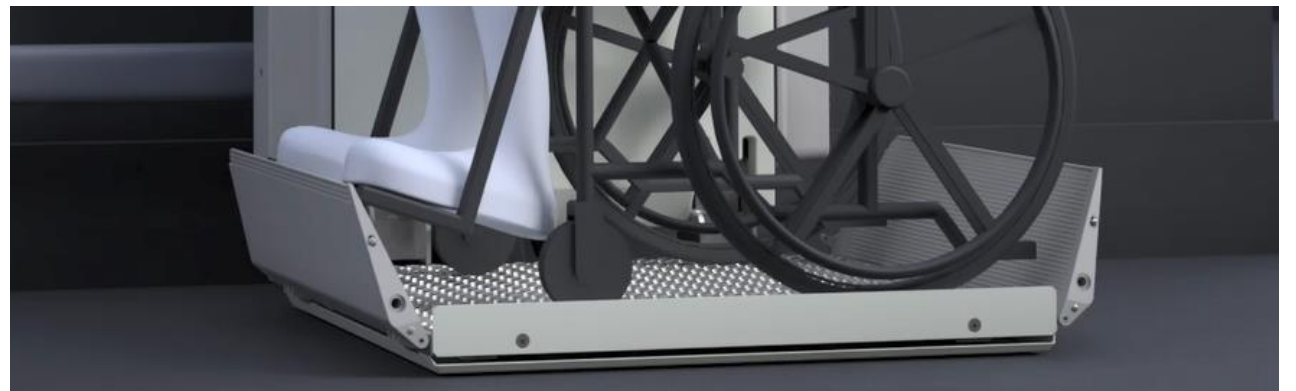

ACCESS – PLATFORM



All the platforms are also equipped with **SAFETY EDGES UNDER THE PLATFORM** – under the platform are in fact installed microswitches able to stop the platform in the event that, moving down, there is any obstacle between the staircase / floor and the platform. Until the obstacle is removed, the platform cannot proceed in its downward movement but can instead climb to allow the removal of the obstacle or the landing on the upper floor.



All platforms can be equipped with an **overload sensor** that aims to check for any overloads of the platform. In case of overload, the inclinometer causes the appropriate indicator light on the display to light and stops the machine.

The inclinometer is standard on the 1250x800 platform.

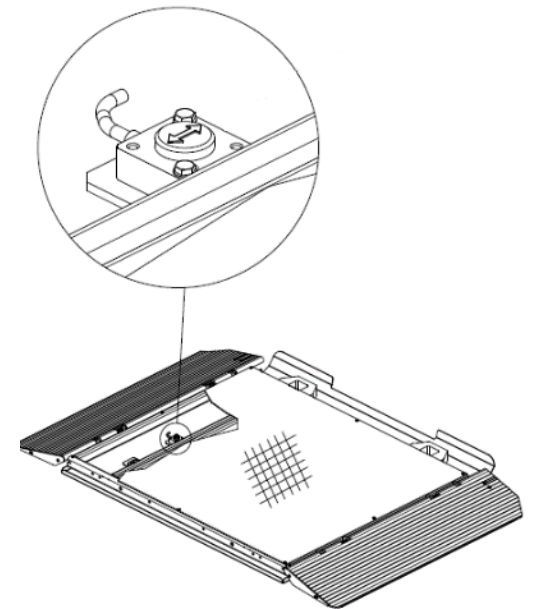

MYVIMEC APP – TECHNICIAN

CONNECTIVITY

The MyVimec app is a very useful tool available to the technician / maintainer because it will allow you to:

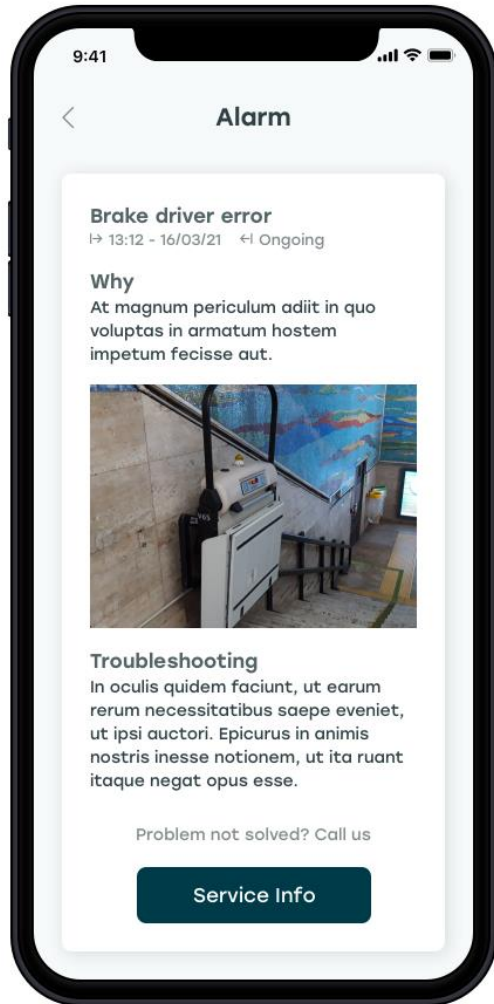

- Receive real-time information on the **status** of the machine (e.g. battery charge level, machine position, etc.)
- Receive real-time information about machine **alarms** or **error** codes and machine recovery instructions
- **Configure** the machine on site
- Carry out **tests** (functionality still being defined)

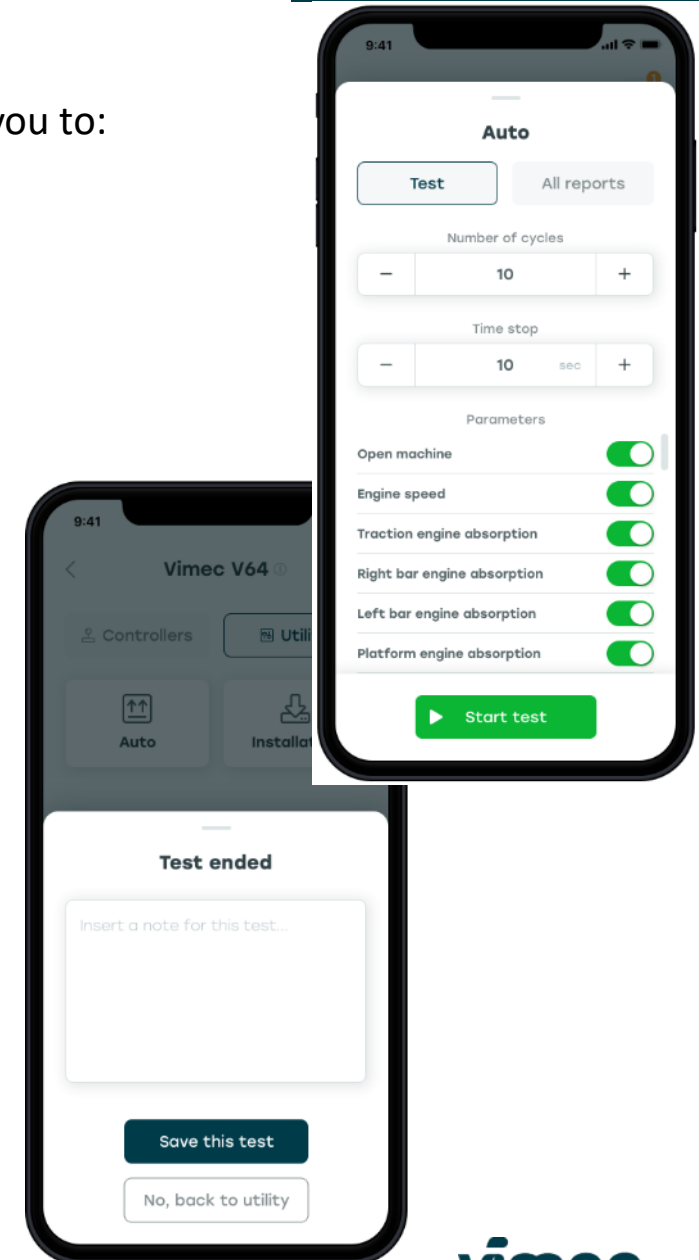

By installing an optional **gateway** device it will be possible to connect V6s to the data network or wi-fi and have information on the machine(s) available on the Cloud.

- **Fleet management:** in one place, all the data of your fleet are available
- Access to customized **dashboards** to consult the statistical data of the machines
- **Preventive maintenance:** through access to the always updated data on the machine, it is possible to prevent any failures in your fleet.

The screenshot displays the vimec dashboard interface. On the left is a navigation sidebar with the vimec logo and user name 'Paolo Rossi'. The main content area is titled 'Overview' and features a map of Northern Italy with a red location pin for 'Trattoria Toscana' in Milan, showing 4 alarms. Two summary cards are present: 'Connected devices' showing 5 devices (17 total) and 'Alarms (Last 24h)' showing 3 alarms. Below these is a 'Latest alarms' section with a dropdown for 'Last 24 hours'. The table lists four recent alarms:

Time	Device ID	Alarm Type	Description	Action
30/09/2021 - 22:34	V6 MA020367457	Display circuit board...	An overheating issue detected on the display circuit board	→
30/09/2021 - 21:11	V6 MA020367459	Appliance safety d...	A security issue that need attention has been detected	→
30/09/2021 - 19:56	V6 FR020367461	Door opened	The door hasn't been closed and the cycle can't start	→
30/09/2021 - 19:23	V6 LA020367460	Disconnected	The device has been disconnected for 42 minutes	→

SALES MEMO – TRACTION

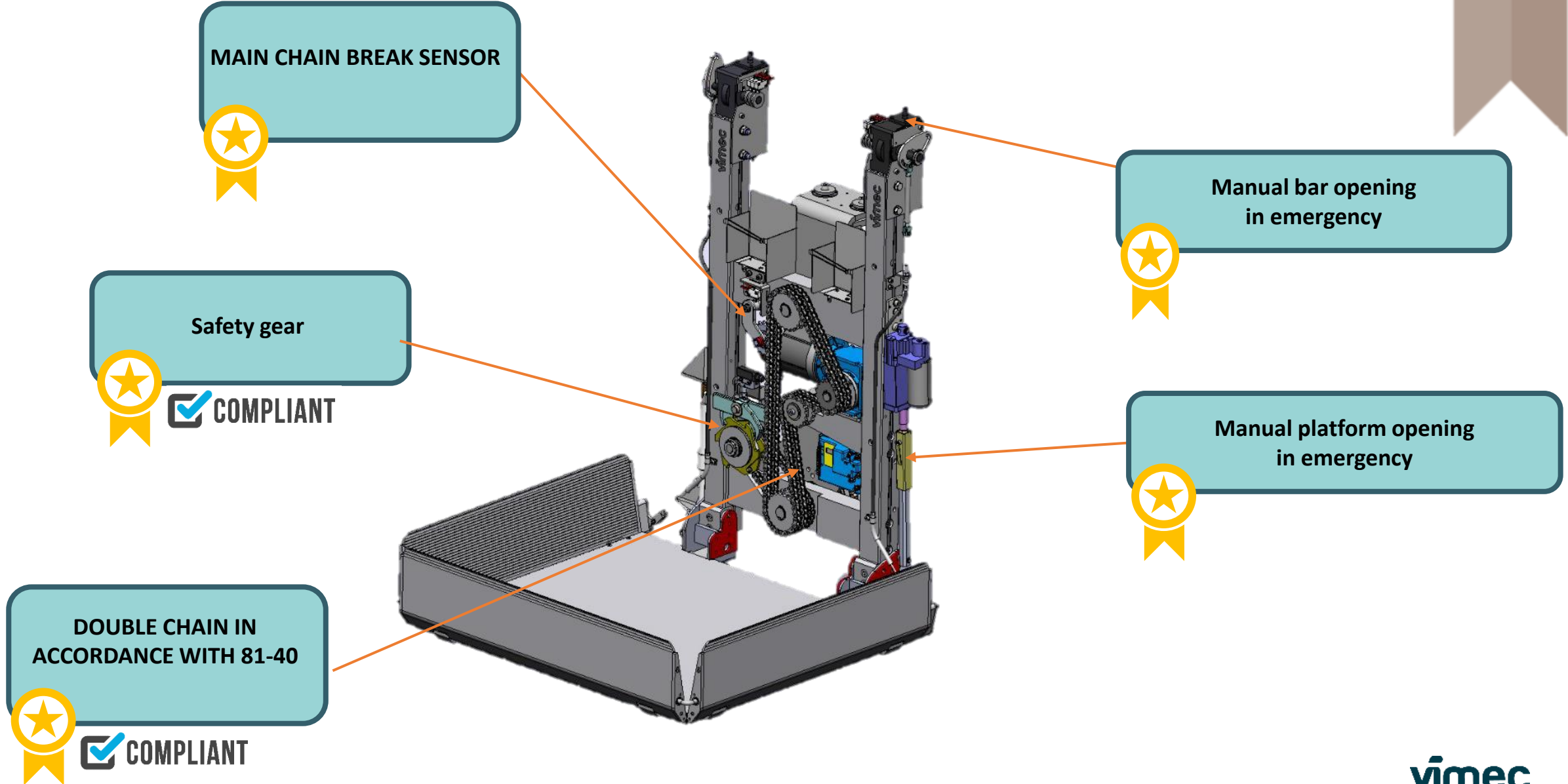

TRACTION

The traction system of the V6s is of the **rack and pinion type** on perforated guides.

V6s provides a standard:

- Double pinion
- Double towing chain equipped with a main chain break sensor (highlighted in **red**)

The mechanical safety gear and speed limiter (highlighted in **blue**) intervene in case of breakage of the traction organs or at a predetermined speed of descent higher than the nominal one.

The intervention of the device causes the machine to stop.

V6s is powered by 2 x 24 Vdc batteries that can be recharged at charging stations.

The power and consumption data from the mains are:

Voltage: 100-300 Vac

Maximum power consumption: 180W

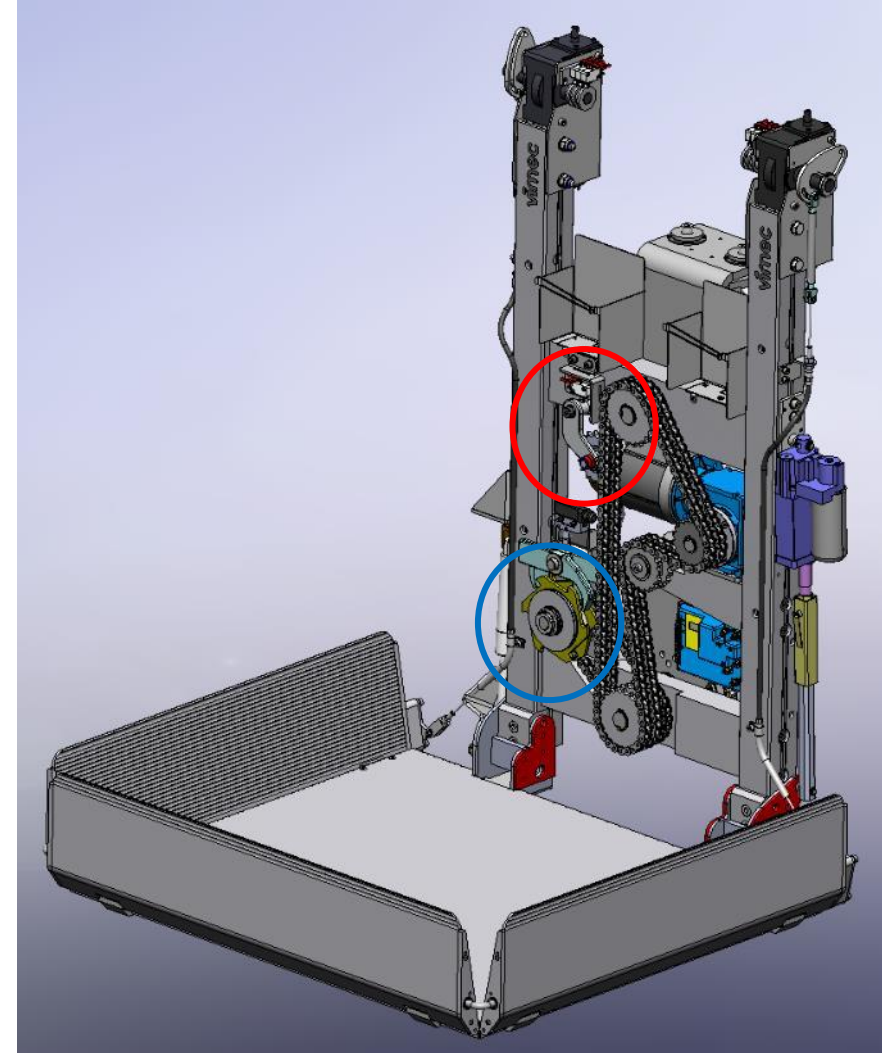



The standard rails of V6s are made of S355 steel and treated with sandblasting, epoxy painting and additional cathodolysis in case of outdoor installations.

The standard color of the guide is **RAL 7024 Anthracite grey**.

N.B. It is possible to request an alternative colouring of the guide by warning the customer about the delicacy of this (in these cases the customer is required to fill out a dedicated form).

The V6s guides have two different sizes depending on the required loading capacity:

- **80 mm x 40 mm with capacity 300 kg**
- **50 mm x 30 mm with capacity 225 kg**

V6s comes standard with 2 charging stations located at the beginning and end of the guide – optionally, you can select them for each intermediate stop provided.

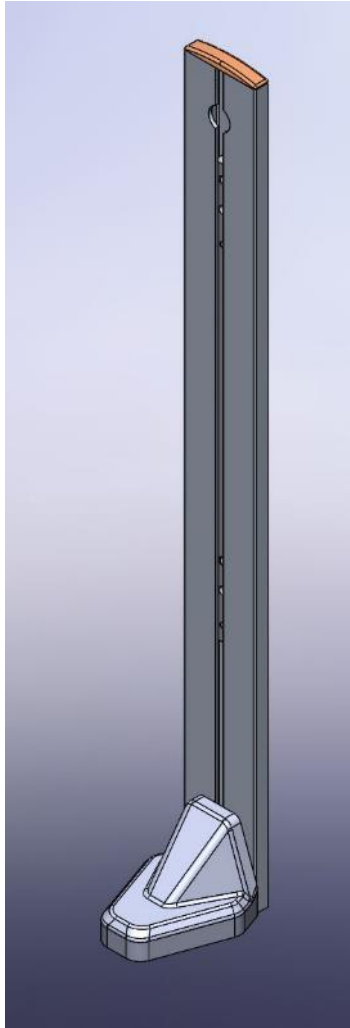

STANDARD SUPPORTS WITH WALL ATTACHMENT

Made of steel RAL 7024

* Supports in aluminium EN AW-6060 T6 available as option

SELF-SUPPORTING PILLARS

Made of steel RAL 7024

* Supports in aluminium EN AW-6060 T6 available as option

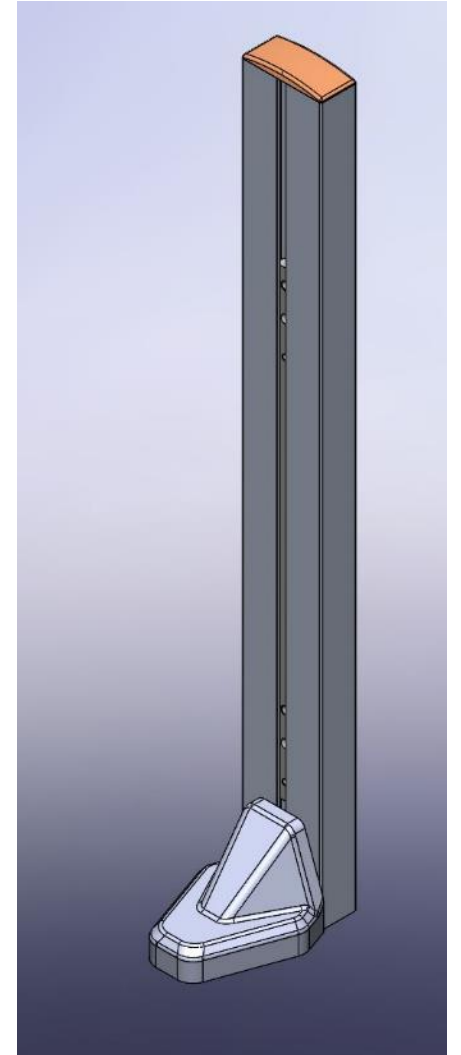



As partly already discussed in the previous slides, V6s integrates numerous devices and measures that place it in first place among competitors in terms of safety.

Below, we list all the main security elements present on V6s:

- **Protection bars**
- **Platform flaps and foot guard**
- **Double chain**
- **Manual unlocking of BARS and PLATFORM**
- **RESCUE MODE**
- **Electric and mechanical limit switches**
- **Shockproof, anti-skinning edges on the machine body and on the platform:** they stop the motion of the machine in contact with any obstacle. However, they allow the movement of the machine in the opposite direction to that in which the obstacle was encountered to free the way.
- **Safety edges under the platform**
- **Safety switches on side bumpers**
- **Inclinometer**
- **Safety gear and speed limiter:** intervenes in case of breakage of the traction organs or at a predetermined speed of descent higher than the nominal one. The intervention of the device causes the machine to stop.

SAFETY – MANUAL UNLOCKING OF BARS AND PLATFORM



SAFETY

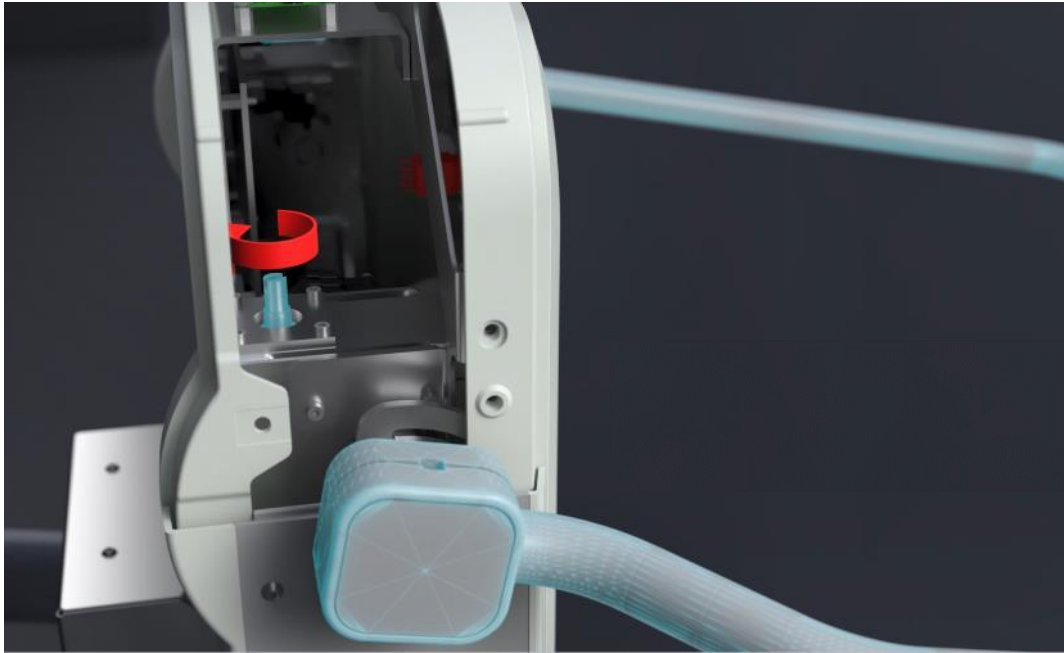

1. MANUAL UNLOCKING BARS

By removing the upper bonnet through a few simple operations, you can manually fold the bars down by acting on the small shaft indicated in the image on the left.

2. MANUAL PLATFORM UNLOCKING

By pressing the lever as shown in the image on the right, you can manually close the platform with the other hand – the operation can also be carried out by a single person.



SAFETY – RESCUE MODE



SAFETY

If the machine is blocked along the stair, it can be moved by a simple manual emergency manoeuvre or "**Rescue mode**". After unlocking the platform and arms, you act on the small shaft circled in red in the image through a tool supplied with the machine.

By turning the tool in the 2 directions it is possible to move the machine up or down.

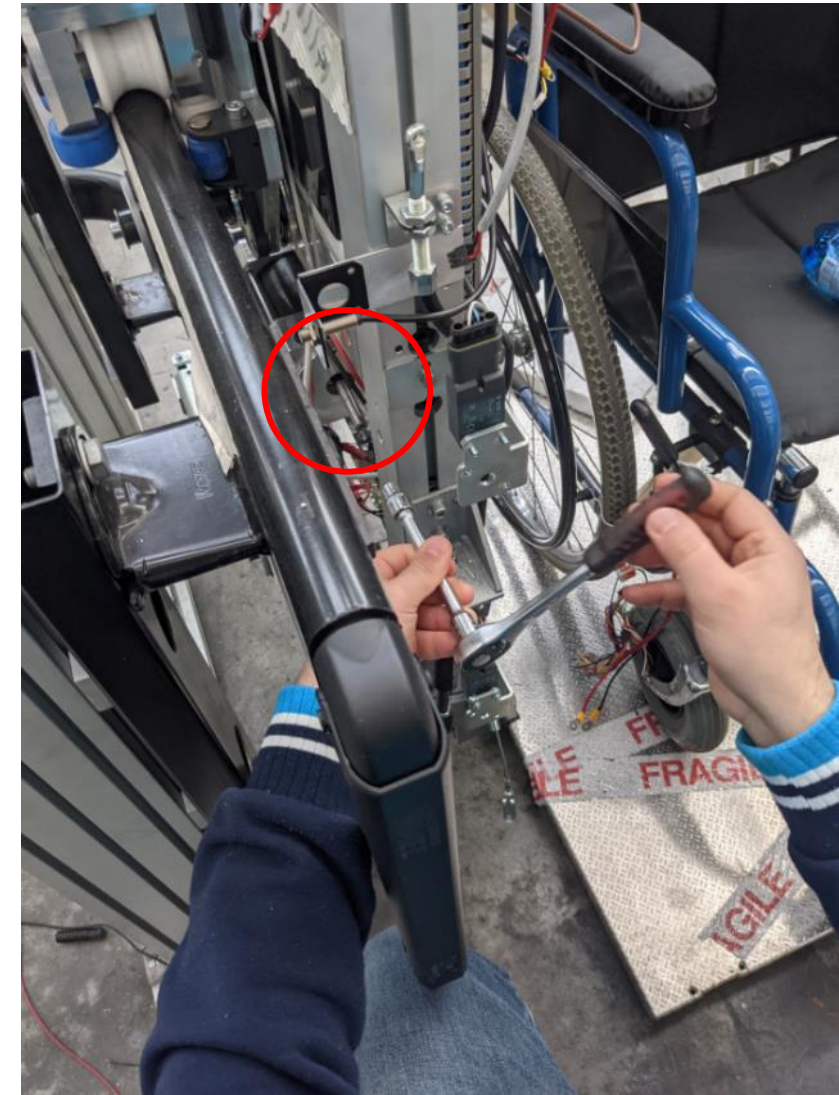

vimec

SALES MEMO – COLORS AND MATERIALS



ANTHRACITE
RAL 7024

- Front cover
- Under-platform
- Footguard

SAME FOR BOTH VERSIONS:

RAL 7047

- Dashboard

RAL 9006

- Handrail
- Side flaps (and front where present)
- Side bumpers and bars
 - Vimec logo

RAL 7024

- Rails and supports



PAPYRUS WHITE

RAL 9018

- Front cover
- Under-platform
 - Footguard

VIMEC

SALES MEMO – COLORS AND MATERIALS



SAME FOR BOTH VERSIONS:

RAL 9006

- Upper hood with satin metal effect
 - Logo Vimec

Natural almond aluminium
footboard

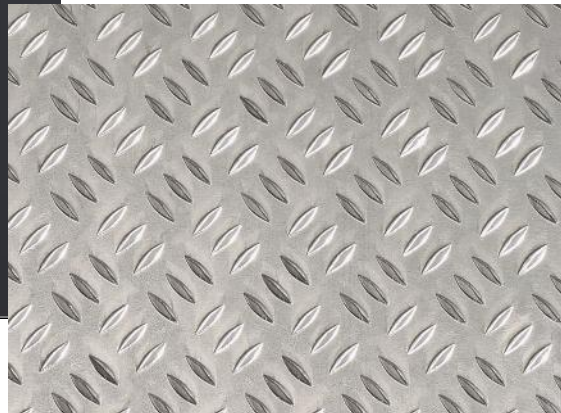

RAL 7024

Rear covers



vimec

SALES MEMO – COLORS AND MATERIALS



RAL 7024

Fitting SMOOTH MATT

Rail SMOOTH

Flange ORANGE-PEEL GLOSSY

Rail end SMOOTH MATT

Foot ORANGE-PEEL GLOSSY

Foot cover SMOOTH MATT



SALES MEMO – SPECIAL RAL COLOURS

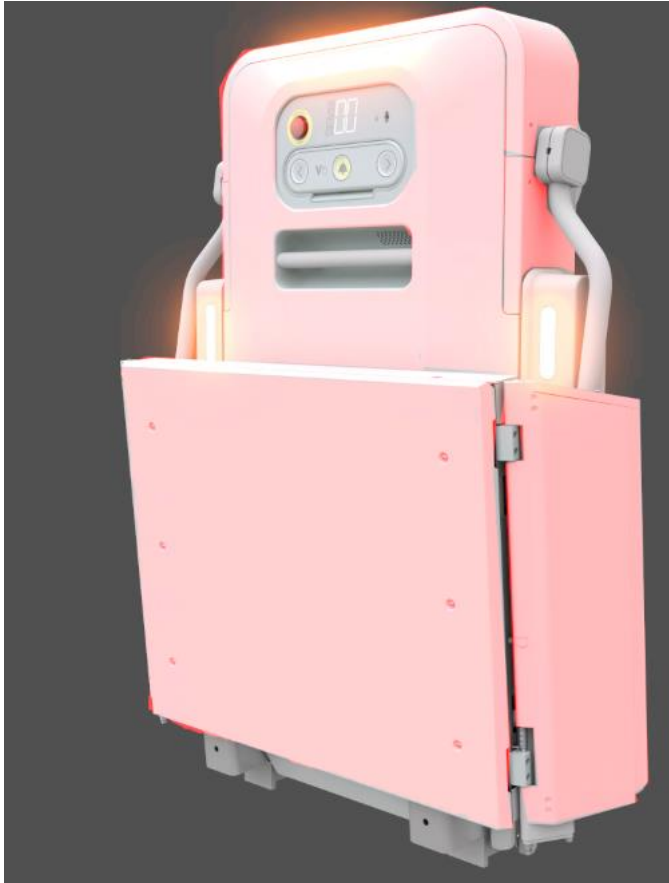

Special RAL colours are available
as option for:

< Front side

(including front cover of
the machine body,
platform double bottom,
flaps and foot guard – side
bumpers and upper hood
not included)

Rear side >

rear cover over the
machine body



Rails and fittings (steel parts only,
plastic covers and closures upon request)

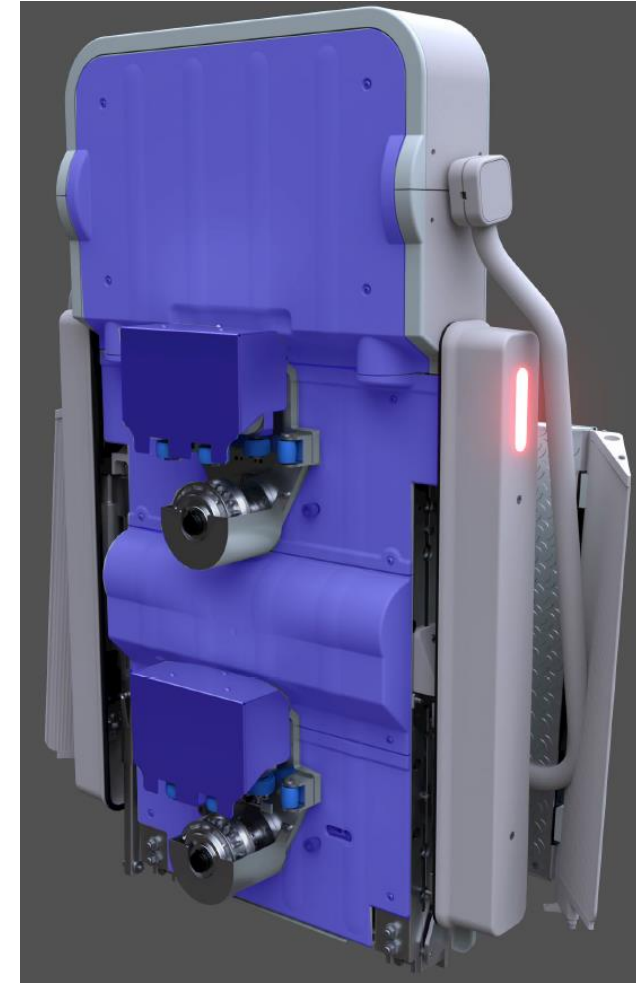

SALES MEMO – COLORS AND MATERIALS



**CUSTOM WRAPPING ON
REQUEST**



ASSEMBLY



**Machine Body in
ALUMINIUM**



**ONE MACHINE BODY FOR
RIGHT/LEFT VERSION**

**ONE MACHINE BODY FOR
INDOOR/OUTDOOR**

**ONE MACHINE BODY FOR ALL
PLATFORM SIZES**

ASSEMBLY



WORK IN PROGRESS

A silhouette of a person climbing a large rock face at sunset. The sun is low on the horizon, creating a bright glow and lens flare. The background shows a dark landscape with mountains under a twilight sky. The word "vimec" is overlaid in white lowercase letters on a dark teal circular background.

vimec